

# OVERALL PRELIMINARY SITE PLAN 7.9

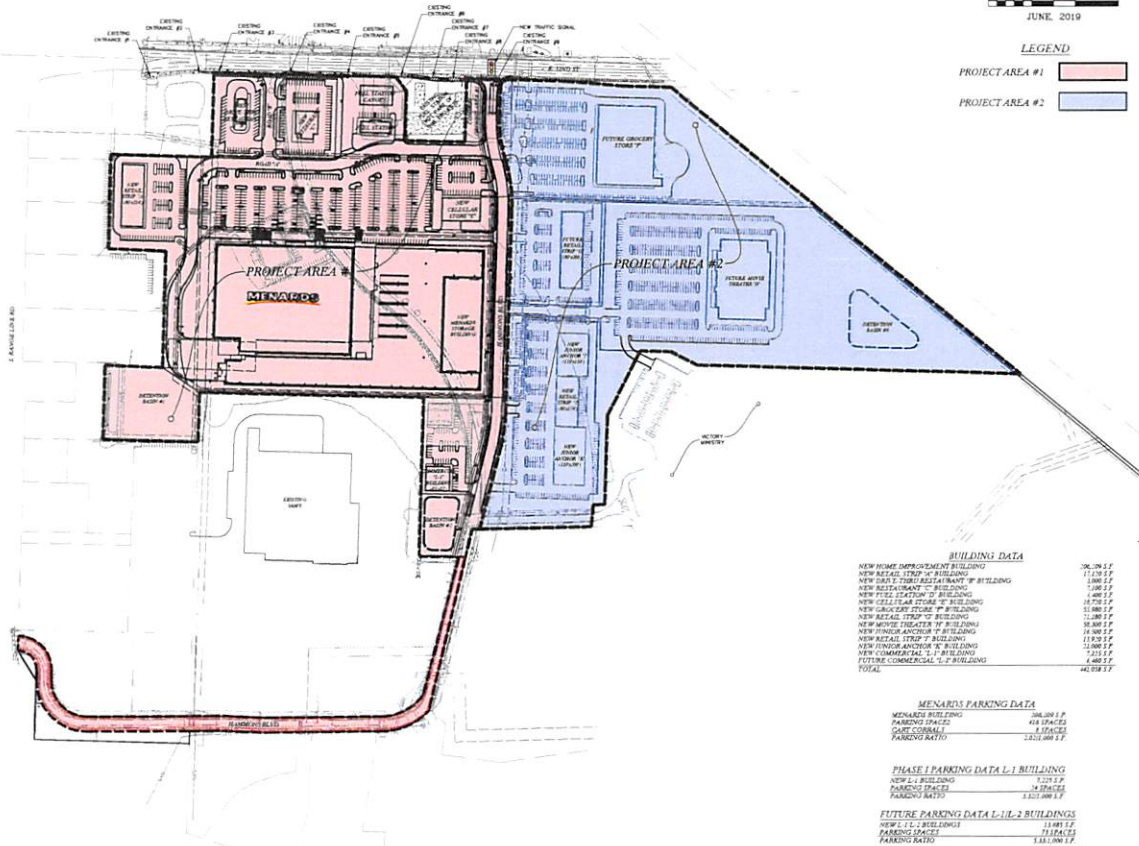

JUNE, 2019

**LEGEND**  
 PROJECT AREA #1 [Pink Box]  
 PROJECT AREA #2 [Blue Box]



**BUILDING DATA**

NEW HOME IMPROVEMENT BUILDING	106,000 S.F.
NEW RETAIL TRIP 'N' BUILDING	17,000 S.F.
NEW FAST-CASUAL RESTAURANT 'B' BUILDING	1,000 S.F.
NEW RESTAURANT 'C' BUILDING	7,000 S.F.
NEW FLEX RESTAURANT 'D' BUILDING	1,000 S.F.
NEW CELLULAR STORE 'E' BUILDING	10,000 S.F.
NEW GAS STATION 'F' BUILDING	11,000 S.F.
NEW RETAIL TRIP 'G' BUILDING	12,000 S.F.
NEW RETAIL TRIP 'H' BUILDING	15,000 S.F.
NEW MOVIE THEATER 'I' BUILDING	10,000 S.F.
NEW FUTURE ANCHOR 'J' BUILDING	10,000 S.F.
NEW RETAIL TRIP 'K' BUILDING	10,000 S.F.
NEW FUTURE ANCHOR 'L' BUILDING	10,000 S.F.
NEW COMMERCIAL 'M' BUILDING	7,000 S.F.
FUTURE COMMERCIAL 'N' BUILDING	6,000 S.F.
<b>TOTAL</b>	<b>442,000 S.F.</b>

**MENARDS PARKING DATA**

MENARDS BUILDING	200,000 S.F.
PARKING SPACES	418 SPACES
GROSS RATIO	2.0 SPACES
PARKING RATIO	2.02 SPACES

**PHASE I PARKING DATA L-1 BUILDING**

NEW L-1 BUILDING	7,275 S.F.
PARKING SPACES	14 SPACES
PARKING RATIO	1.33 SPACES

**FUTURE PARKING DATA L-1/L-2 BUILDINGS**

NEW L-1 BUILDINGS	31,000 S.F.
PARKING SPACES	711 SPACES
PARKING RATIO	1.33 SPACES

OCHAN  
 CIVIL ENGINEERING & ARCHITECTURE  
 1000 S. W. 10TH AVE., SUITE 100  
 MIAMI, FL 33135  
 TEL: 305.444.1000  
 FAX: 305.444.1001  
 WWW.OCHAN.COM

SITE IMPROVEMENTS  
 MENARDS  
 JOPLIN, MISSOURI

OVERALL PRELIMINARY SITE PLAN 7.9  
 DATE: JUNE 12, 2019  
 SCALE: 1" = 150'  
 SHEET NO: 18-7526  
 7.9