



STAFF PLANNING REPORT Rezoning

CASE 042-18 A request to declare surplus property
LOCATION 1524 S. Moffet Avenue
APPLICANT City of Joplin

EXISTING CONDITIONS

Zoning	Land Use	Property Size
R-1	Vacant	.15 acres

SITE CONTEXT

	North	East	South	West
Existing Zoning	R-1	R-2	R-1	R-1
Land Use	Single Family Residential	Two-Family Residential	Single Family Residential	Single Family Residential

TRANSPORTATION

Streets with access	Classification	Right-of-way width
16th Street	Secondary	50'
Moffet Avenue	Secondary	60'

FLOOD PLAIN The property is not within the 100-year flood zone.

STAFF ANALYSIS

WILL THE PUBLIC SUFFER A LOSS OR INCONVENIENCE BY THE VACATION OF RIGHTS TO THE PROPERTY?

No.

REASON FOR DECLARATION

The City of Joplin no longer has need of this property. It has become burdensome for the city to continue mowing the grass on this lot. This is a buildable lot, and the dimensions are approximately 50 feet by 125 feet.

ADDITIONAL INFORMATION OR COMMENTS

None.

Staff recommends approval of Case 042-18

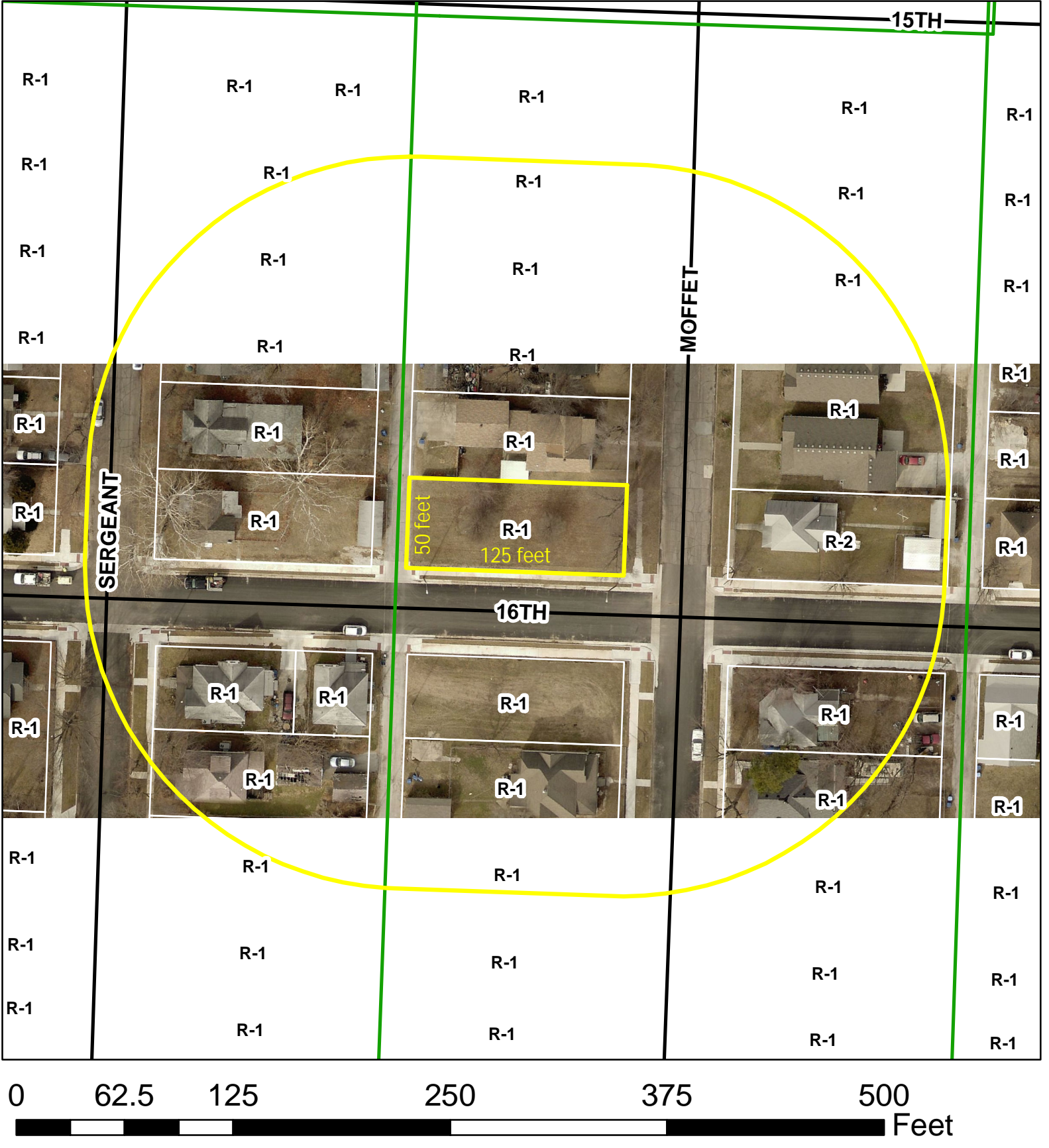

Case 042-18: 1524 S. Moffet Avenue -- A request to declare surplus property -- City of Joplin